

SECTION 01 THROUGH BROADCAST CENTRE AND BURGHLEY HOUSE

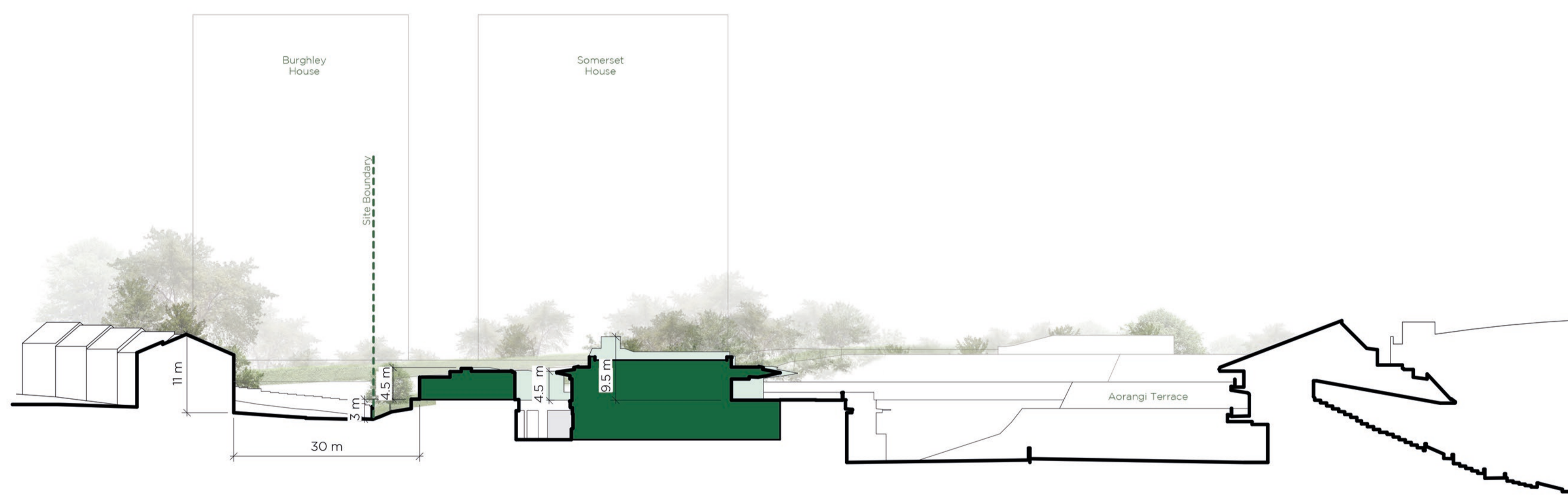

SECTION 02 THROUGH SOMERSET ROAD, BROADCAST CENTRE, AND NO.1 COURT

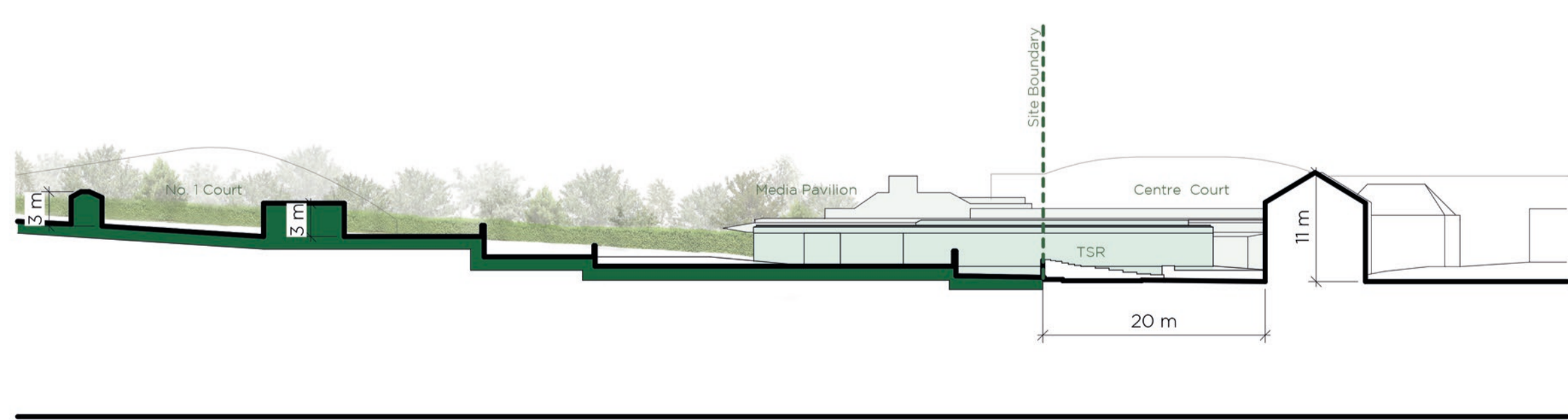

SECTION 03 THROUGH SOMERSET ROAD AND GATE 20 YARD

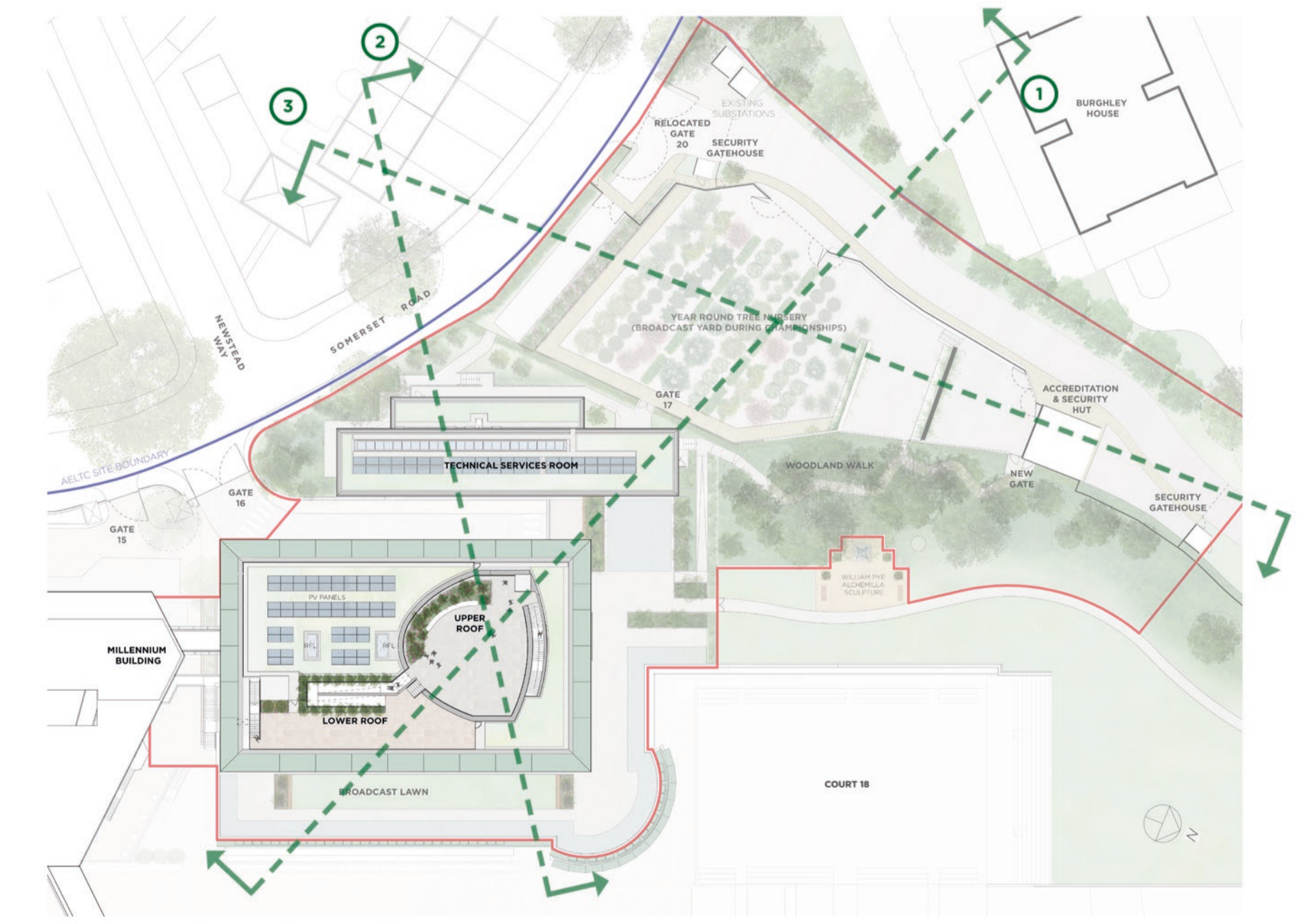

Rev.	Date	Description
PO0	25/11/2019	Issued for Planning
PO1	28/11/2019	Issued for Planning
PO2	13/12/2019	Issued for Planning

Notes
 1. To be read in conjunction with all relevant information
 2. Do not scale from drawing



LANGSTAFF DAY ARCHITECTS		<i>project</i> Media Development Project	<i>rev.</i> P02
address 321 Edinburgh House, 170 Kennington Lane London SE11 5DP		<i>for</i> AELTC	
e-mail office@langstaffday.co.uk		<i>title</i> Site Sections - Proposed	
<i>suitability</i> S3 - For Review and Comment	<i>scale</i> 1:500@A1 1:1000@A3	<i>drawing number</i> 51336-LDA-0010-XX-DR-A-0071	

This page is intentionally left blank